

CITY OF VALLEY PARK
 320 Benton Street
 Valley Park, MO. 63088
 (636) 225-2676



**SIGN
 PERMIT / APPLICATION**

2 SETS OF PLANS REQUIRED

DATE: _____

- PERMANENT SIGN
 TEMPORARY SIGN

OFFICE USE ONLY

PERMIT NUMBER: _____

- FEE: \$ _____ BAL DUE: \$ _____
 INSP. \$ _____ BAL DUE: \$ _____

OWNERSHIP INFORMATION

SIGN ADDRESS:	
PROPERTY OWNER:	
SUBDIVISION / SHOPPING CENTER:	
PERMITTEE:	CONTACT PERSON:
ADDRESS:	PHONE:
CITY/STATE/ZIP:	EMAIL:

CONTRACTOR INFORMATION

NAME:	CONTACT PERSON:
ADDRESS:	PHONE:
CITY/STATE/ZIP:	EMAIL:

PERMANENT SIGN INFORMATION

- GROUND CONSTRUCTION
 WALL REAL ESTATE
 DIRECTORY SUBDIVISION
 OTHER: _____

- ONE-SIDED TWO-SIDED

SIGN DIMENSIONS: _____ x _____
 SIGN MATERIAL: _____
 TOTAL HEIGHT FROM GROUND: _____ FT
 ELECTRICAL CONNECTION? Y N
 ELECTRICAL PERMIT REQUIRED: Y N

TEMPORARY SIGN INFORMATION

- BANNER INFLATABLE
 MOVING FLAT
 GROUND WALL
 ONE-SIDED TWO-SIDED

SIGN DIMENSIONS: _____ x _____
 SIGN MATERIAL: _____
 TOTAL HEIGHT FROM GROUND: _____ FT

DATES SIGN TO BE DISPLAYED:

FROM _____ TO _____

REMOVED? **Y** **N** DATE: _____ INSP _____

Signature of Applicant

SITE INFORMATION

- ~ Label the streets surrounding the property
- ~ Show the location of the sign on the site
- ~ Dimension—how far the sign will be placed from the curb.

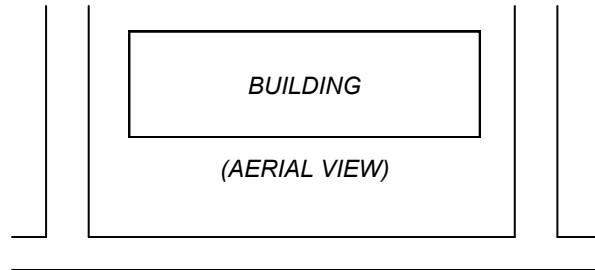

BUILDING INFORMATION

- ~ Show the location of the sign on the sample storefront below, if applicable

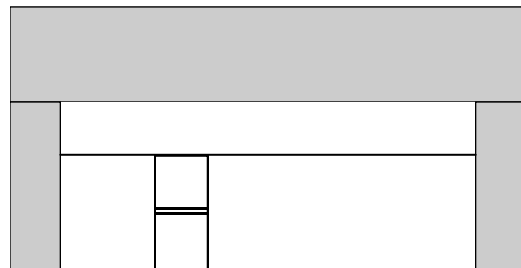

<p>_____</p> <p>_____</p>	REVIEWED
	Date